Python Script : DXF-Section

This script allows to generate a ".dxf" file of a beam having a cross section similar to that represented in figure 1.

The required input data are :

$$b_0, b_t, b_{ta}, b_g, b_a, h_p, h_d, h_t, h_0, h_g, h_1, h_2$$

To run this script you have to install "Python" programming language and its library "dxfwrite 1.2.0".

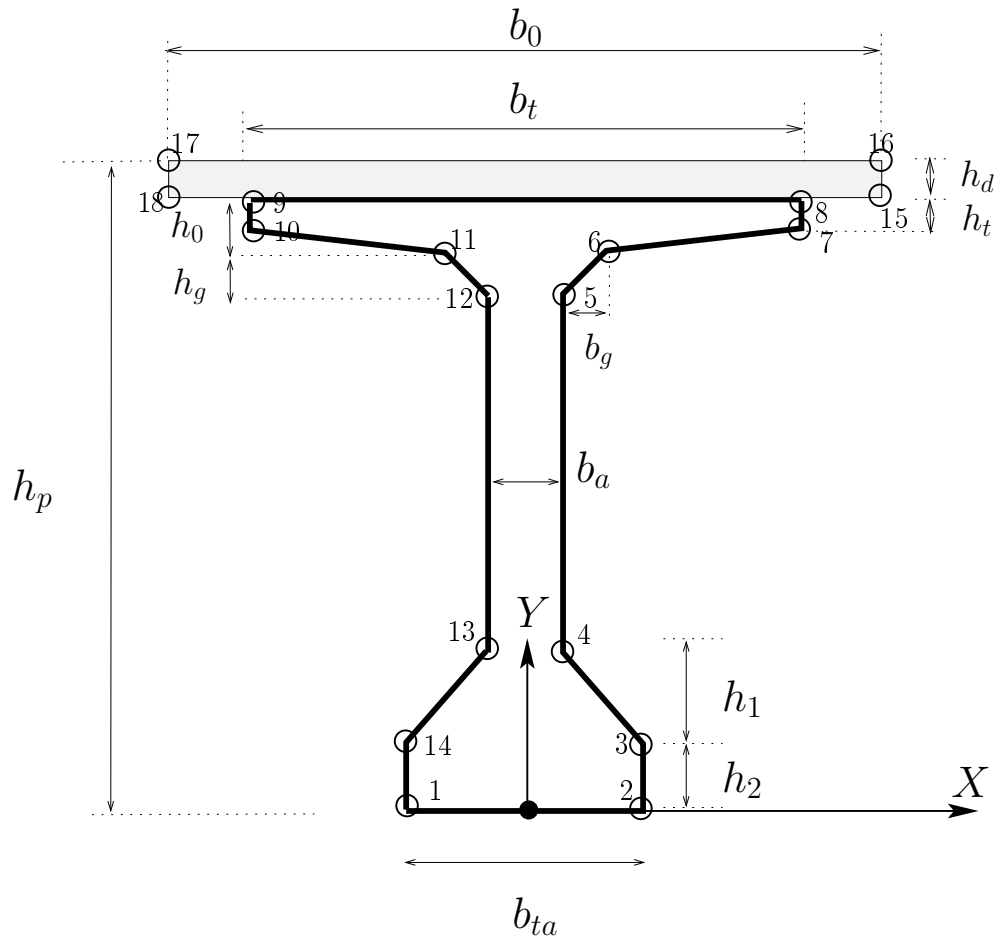

FIGURE 1 – Beam cross section